

B500016

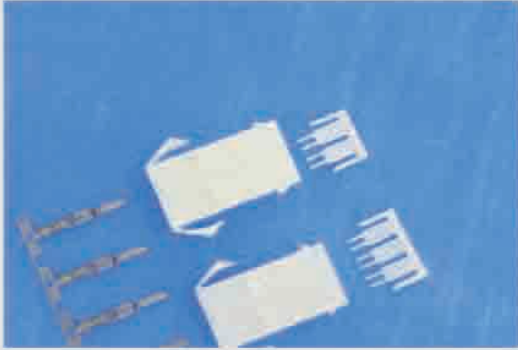

- ▶ **主要技术特性 (Main Specifications)**
- ▶ 适用导线规格 (Applicable wire) : AWG24#~18#
 - ▶ 适用基板厚度 (Applicable PC board thickness) : —
 - ▶ 温度范围 (Temperature range) : -25°C~+85°C
 - ▶ 额定电压 (Voltage rating) : 250V AC, DC
 - ▶ 额定电流 (Current rating) : 3A AC, DC
 - ▶ 接触电阻 (Contact resistance) : $\leq 0.02\Omega$
 - ▶ 绝缘电阻 (Insulation resistance) : $\geq 1000M\Omega$
 - ▶ 耐压 (Withstanding voltage) : 1500V AC/minute

材料及电镀规格 Material and Finish

型号 Type	材料 Material	材料厚度 Material Thickness	电镀规格 Finish
孔座 HOUSING	PA66 UL94V-0	—	N/A
端子 TERMINAL	锡青铜 Phosphor bronze	0.3mm	镀锡 Tin-plated

产品尺寸图 Product size chart

 单位: mm 一般公差: ± 0.20

TERMINAL

- B500016-3 18822-M2
B500016-3-I 18821-M2

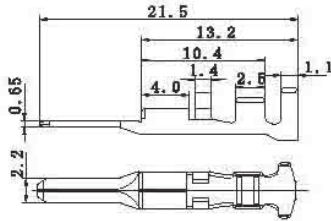

HOUSING

- B500016-5-02 5190-4202 B500016-5-03 5190-4203

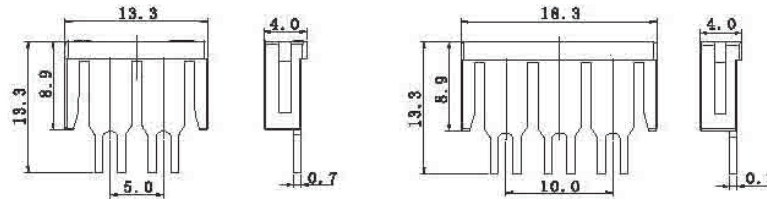

HOUSING

- B500016-1-03 5110-4203

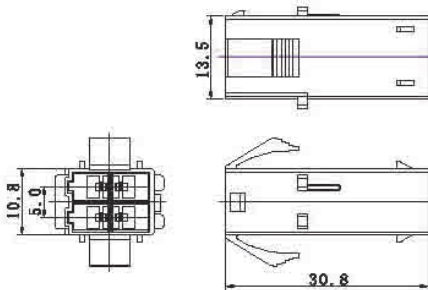

HOUSING

- B500016-1-04 5110-4204

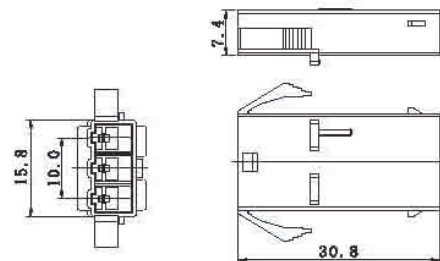

HOUSING

- B500016-1-06 5110-4206

